

TAX MAP INDEX

TOWN OF FAYETTE

METHOD OF NUMBERING PARCELS WHEN LANDS ARE DIVIDED OR SUBDIVIDED:



1. SAMPLE PARCEL SECTION-4, BLOCK-2, PARCEL-12
2. WHEN A PARCEL IS DIVIDED INTO TWO PARCELS, THE PARCEL SOLD OFF BECOMES 4-2-12.2 AND THE RETAINED PORTION BECOMES 4-2-12.1
3. WHEN A PARCEL IS RESUBDIVIDED SUCH AS 4-00-2-12.1, THE PARCEL SOLD OFF BECOMES 4-00-2-12 AND THE RETAINED PORTION BECOMES 4-00-2-12.11
4. WHEN SUBSEQUENT DIVISION TAKES PLACE, THE PARCEL RETAINED IS ALWAYS NUMBERED WITH THE SUFFIX "1" WHILE THE SOLD OFF PARCEL IS SUFFIXED STARTING WITH "2" & NUMBERING UP CONSECUTIVELY.
5. IF A PARCEL IS MADE INTO A "SUBDIVISION" CONTAINING MANY LOTS, A NEW BASE NUMBER IS GIVEN EACH LOT RATHER THAN USING THE PROCEDURE EXPLAINED ABOVE.

TAX MAP SCALE: SEE SCALE ON EACH SECTION MAP
 NUMBERING OF PARCELS:

EACH TOWN IN THE COUNTY OF GENESEE HAS BEEN DIVIDED INTO "SECTIONS" DESIGNATED THUS - ① ALL SECTIONS CONTAIN FROM TWO TO EIGHT FARM LOTS. WITHIN EACH SECTION ARE AREAS BOUNDED BY ROADS, RAILROADS, WATERWAYS OR OTHER NATURAL BOUNDARIES, WHICH ARE DESIGNATED AS "BLOCKS". EACH LOT OR "PARCEL" WITHIN THE BLOCK IS NUMBERED CONSECUTIVELY, STARTING IN THE NORTHWEST CORNER OF EACH BLOCK AND PROCEEDING CLOCKWISE.

THEFORE THE PARCEL NUMBER FOR A SPECIFIC PROPERTY IS A COMBINATION OF THE NUMBERS OF THE SECTION, BLOCK AND PARCEL. FOR EXAMPLE, PARCEL NUMBER 4-2-12 MEANS THAT THE PROPERTY MAY BE FOUND ON SECTION MAP - 4, IN BLOCK - 2, AND THE SPECIFIC PARCEL NUMBER IS 12.

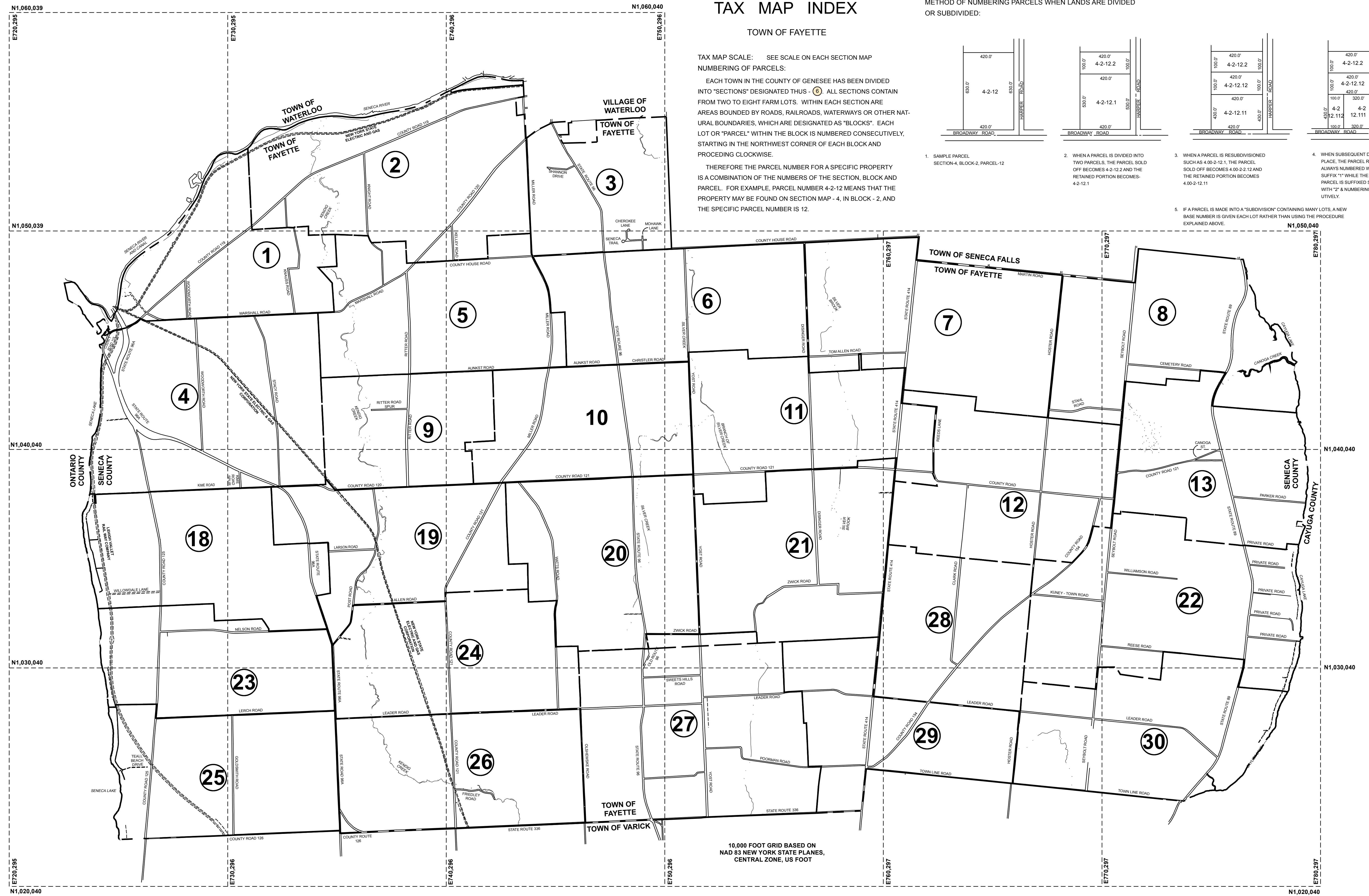

10,000 FOOT GRID BASED ON NAD 83 NEW YORK STATE PLANES, CENTRAL ZONE, US FOOT

PREPARED BY
McINTOSH & McINTOSH, LAND SURVEYORS
 BATAVIA, NEW YORK
 UNDER AUTHORITY OF
SENECA COUNTY BOARD OF SUPERVISORS
 FOR TAX PURPOSES ONLY

THIS MAP WAS PREPARED FOR TAX PURPOSES ONLY AND IS NOT TO BE REPRODUCED OR USED FOR SURVEYING OR CONVEYANCING. MAP CONVERTED TO DIGITAL TAXMAP FORMAT AUGUST 2008 BY
WEILER MAPPING
 A DIVISION OF JAMES W. SEWELL COMPANY
 150 North Main Street, Suite 400, Elmira, NY 14901
 TEL: 607-737-1968
 FAX: 607-737-3618

REVISION TABLE		
DATE	MADE BY	CHANGES OR ADDITIONS

SPECIAL DISTRICTS	
SCHOOL	
FIRE	
WATER	

LEGEND	
PROPERTY LINE	---
ORIGINAL LOT LINE	---
RAILROAD	—+—+—+—
STREAM OR DITCH	~~~~~
ROAD OR RAILROAD BNDY.	—+—+—+—
COUNTY LINE	---
TOWN LINE	---
VILLAGE LINE	---
BLOCK LIMIT	---
GREAT LOT LINE	---
SCHOOL DISTRICT LINE	---
FIRE DISTRICT LINE	---
WATER DISTRICT LINE	---
DENOTE COMMON OWNER	---
RESERVATION BOUNDARY	---

TAX MAP BLOCK No	①	43-17-11
TAX MAP PARCEL No	②	14
FILED PLAN LOT No	③	17.5 A
GREAT LOT No	④	17.5 A
CALCULATED ACREAGE	⑤	225 (S)
DEED ACREAGE	⑥	173.2
SCALED DIMENSION	⑦	173.2
DEED DIMENSION	⑧	173.2

TAX MAP
TOWN OF FAYETTE
 SENECA COUNTY, NEW YORK
 GRAPHIC SCALE
 1" = 2000'

MAP DATE 3/72
INDEX MAP
 SECTION MAP